



P R I M E R E S I D E N T I A L

P R E S E N T S

Connaught Court, The Chequers, Hills Road, Buckhurst Hill



## Connaught Court, The Chequers, Hills Road,



Elliott James is proud to present this super two bedroom ground floor apartment. Situated in a modern gated development close to Epping Forest, Queens Road shops and Buckhurst Hill Central Line Station.

The apartment comprises of entrance hallway, open plan living/dining room, contemporary kitchen with integrated appliances, bathroom, master bedroom with fitted wardrobes and a further double bedroom. We are advised that the property was fully refurbished in 2017 to include re wiring, re plumbing, new kitchen, new bathroom and new flooring.

Externally there is easy access to the communal area, an allocated parking space and a further parking space in a car port.

Offered to the market with share of the freehold, an early viewing is advised.



N  
E  
E  
D  
  
T  
O  
  
K  
N  
O  
W

Sqft 663.00 sq ft	Type Apartment	Style Modern
Bedrooms 2	Receptions 1	Bathrooms 1
Tenure Leasehold - Share of Freehold	Local Authority Epping Forest District Council	Tax Band D

# PLANS

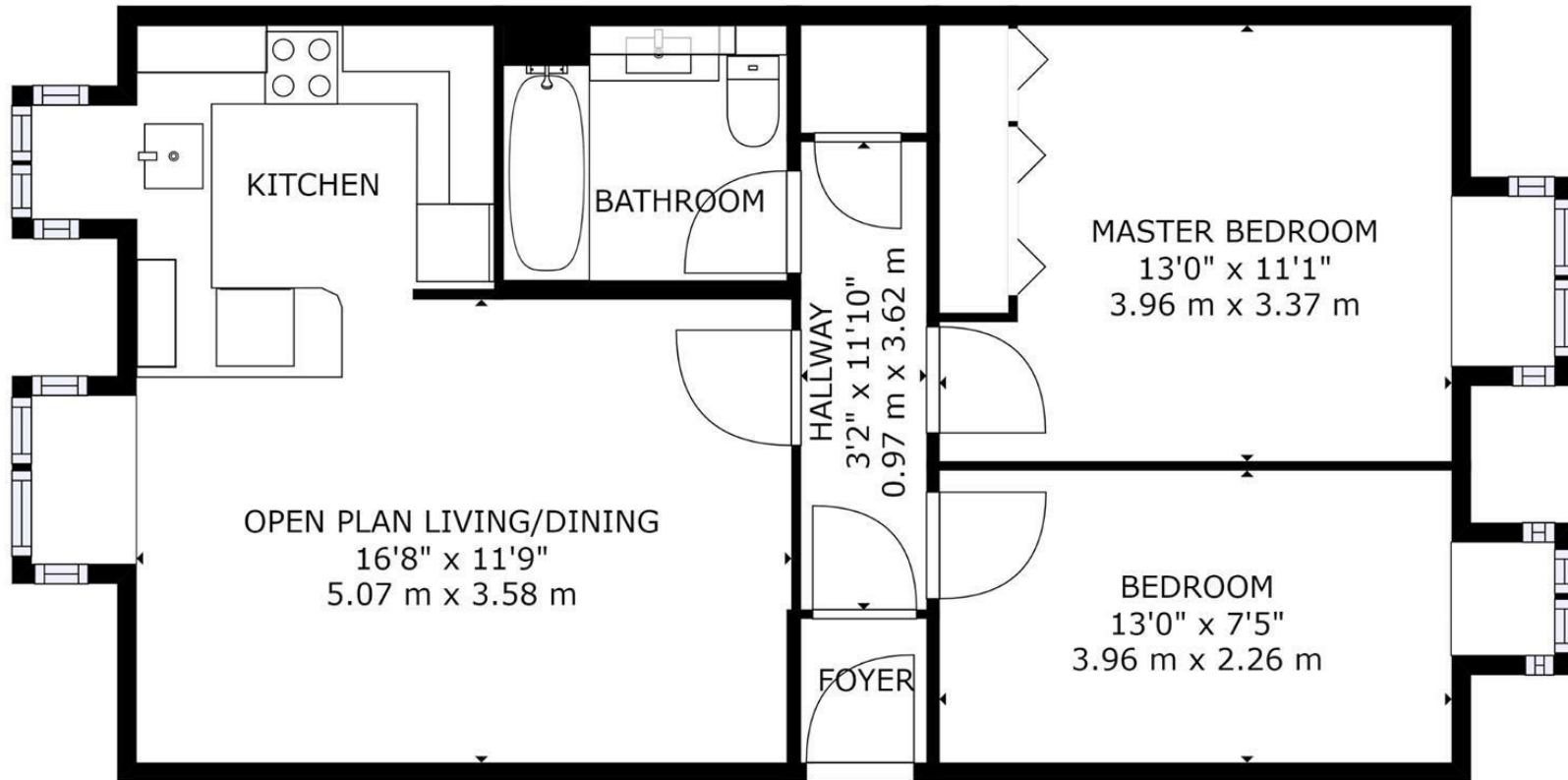

FLOOR 1

GROSS INTERNAL AREA  
FLOOR 1: 663 sq. ft, 62 m<sup>2</sup>  
TOTAL: 663 sq. ft, 62 m<sup>2</sup>  
SIZES AND DIMENSIONS ARE APPROXIMATE, ACTUAL MAY VARY.



# MAP & EPC

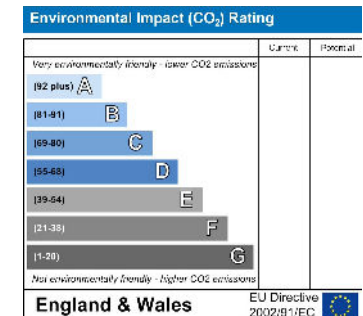
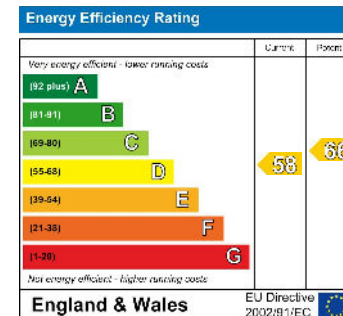
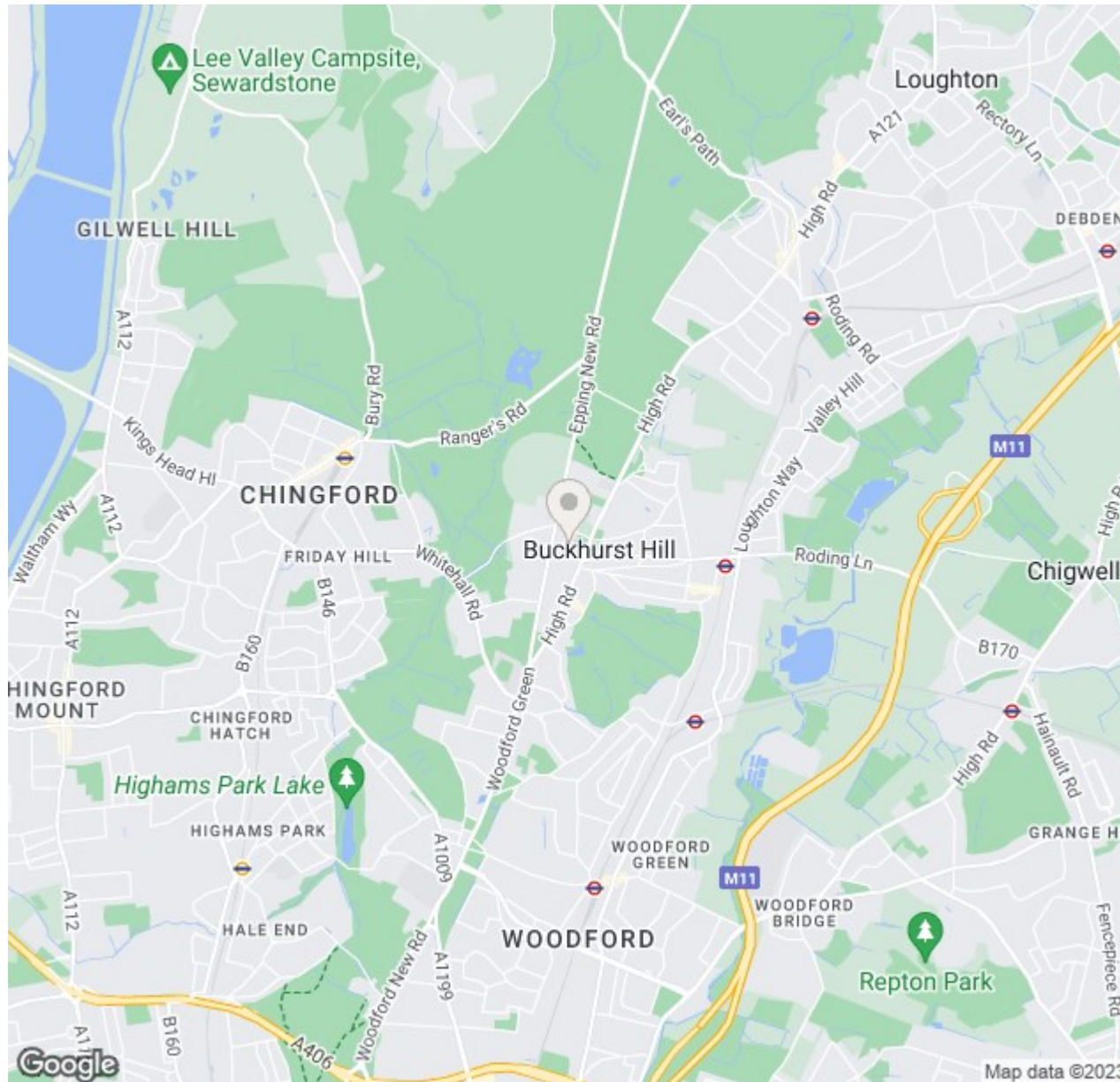

elliott  james

165 | High Road | Loughton | IG10 4LF

Contact Us : 0208 0165 333 | [contact@ejpr.co.uk](mailto:contact@ejpr.co.uk)

Follow us on social media | Search 'ejpr165'



These particulars have been prepared with approximate measurements in good faith by Elliott James - Prime Residential with the assistance of the vendor. The intention is to provide a fair and accurate guide to the property. These details do not constitute or form any part of an offer or contract. All interested parties must verify for themselves the accuracy of the information provided. The structural condition of the property or the condition of the heating, plumbing or electrical installations or any appliances have not been checked or tested and suitable investigations by interested parties should be conducted prior to purchase.