



P R I M E R E S I D E N T I A L

P R E S E N T S

Smarts Lane, Loughton



Smarts Lane, Loughton



Nestled off of Smarts Lane is this charming Victorian three bedroom family home. Situated in a unique and peaceful location within walking distance to Epping Forest, Loughton High Street and Central Line Station.

This charming home is set over three floors with the ground floor comprising open plan bright living / dining room with fireplace, modern kitchen with integrated appliances and contemporary family bathroom. On the first floor there are two bedrooms both with fitted wardrobes and on the top floor a large master bedroom with Juliet balcony and stylish fully tiled en-suite shower room.

Externally there is a pretty low maintenance rear garden with artificial grass, a decking area perfect for summer entertaining and a gate providing rear access.

The property is offered in an immaculate condition and an early viewing is highly advised.



N
E
E
D

T
O

K
N
O
W

Sqft 804.00 sq ft	Type House - Mid Terrace	Style Victorian
Bedrooms 3	Receptions 1	Bathrooms 2
Tenure Freehold	Local Authority Epping Forest District Council	Tax Band D

PLANS

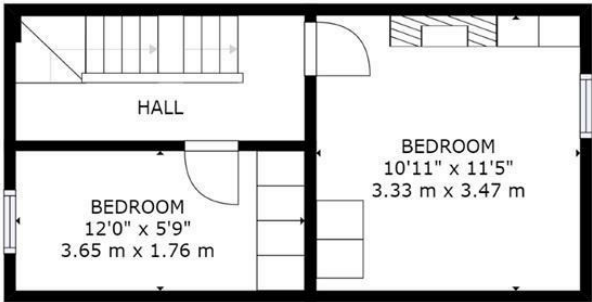

FLOOR 2



FLOOR 3

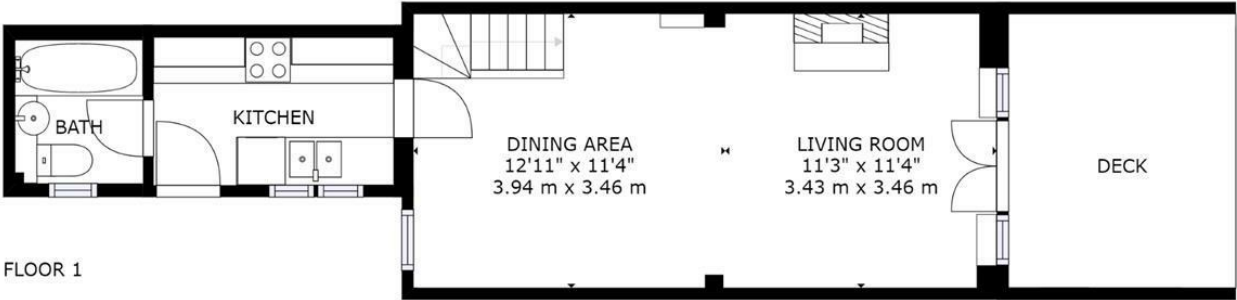

FLOOR 1

GROSS INTERNAL AREA
FLOOR 1: 375 sq. ft, 35 m², FLOOR 2: 266 sq. ft, 25 m²
FLOOR 3: 163 sq. ft, 15 m², EXCLUDED AREAS:
REDUCED HEADROOM BELOW 1.5M: 10 sq. ft, 1 m²
TOTAL: 804 sq. ft, 75 m²
SIZES AND DIMENSIONS ARE APPROXIMATE, ACTUAL MAY VARY.



MAP & EPC

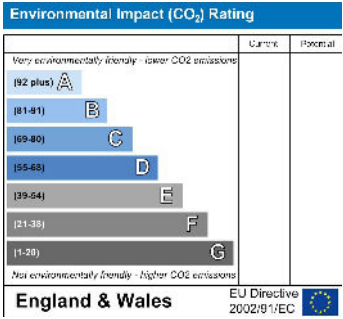
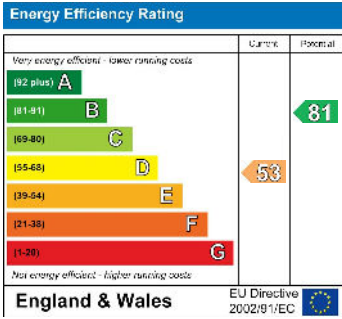
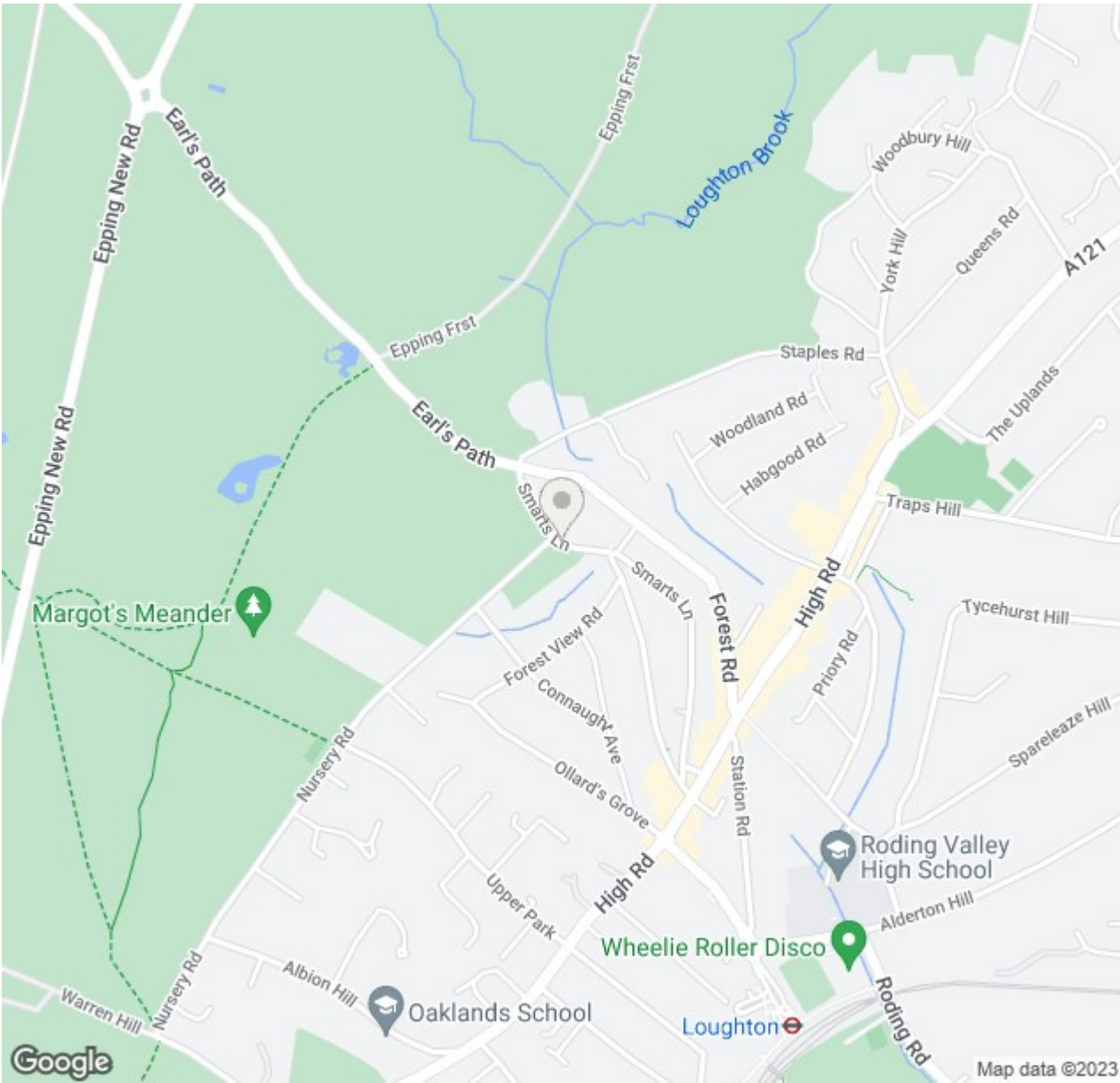

elliott  james

165 | High Road | Loughton | IG10 4LF

Contact Us : 0208 0165 333 | contact@ejpr.co.uk

Follow us on social media | Search 'ejpr165'



These particulars have been prepared with approximate measurements in good faith by Elliott James - Prime Residential with the assistance of the vendor. The intention is to provide a fair and accurate guide to the property. These details do not constitute or form any part of an offer or contract. All interested parties must verify for themselves the accuracy of the information provided. The structural condition of the property or the condition of the heating, plumbing or electrical installations or any appliances have not been checked or tested and suitable investigations by interested parties should be conducted prior to purchase.